

EDM Wire

Supplement to Wire-cut EDM Products Catalog
Effective April 26, 2004

- NOTE -

*THIS SUPPLEMENT REPLACES THE ENTIRE WIRE SECTION
OF THE EXISTING INTECH EDM WIRE-CUT CATALOG*

INTECH EDM® 

Contents - Section 2

Subject/Contents	Page
Important Notes About This Catalog Supplement	2
Technical Notes About Wire Spools and Wire Length	3
SuperBrass 500®	4-5
SuperBrass 900® – Hi-tensile	6-7
Standard Brass	8
Standard Half Hard Brass	9
OKI P Brass – Hi-tensile	10
OKI PN Brass – Hi-tensile	11
Soft Brass.....	11
Alphacut® 500 Standard Tensile	12
Alphacut® 800 Hi-tensile.....	13-14
Cobra Cut® A.....	15
AgieCut A	16-17
Alphacut® D Hi-tensile	18
AgieCut SWD	19
Deltacut® 500	19
Deltacut® One	20
Deltacut® 900	21
Betacut® X.....	22-23
Charmilles Wire SW-X	24
Charmilles Wire SW	25
Charmilles Wire SW-W	25
Charmilles Wire SW-Xcc	26
Multicut 900® Steelcore	27
Molybdenum Wire 15.....	28

EDM

**U.S.A. Toll-free
1-800-323-0295**
Canada Toll-free
1-800-243-5853

Important Notes About This Catalog Supplement:

Intech EDM is experiencing many changes with our various suppliers of EDM wire. Primarily, these have been caused by Rea Wire's recent decision to exit the EDM wire business. Rea was the last significant producer of EDM wire in the United States, and manufactured many of our EDM wire products.

As a result, we have been actively working with alternative wire suppliers, in other countries, to replace those products which were manufactured by Rea with equivalent wire products. In some cases, this will not be possible and we will be transitioning our customers to acceptable alternatives, based on their applications.

The rapid and ongoing changes we are experiencing have necessitated our preparing this supplement to our existing wire-cut EDM products catalog. We will update this supplement as necessary in the ensuing months, and urge you to refer to the effective date as printed on the cover to ensure you are working with the latest information. If in doubt, you should check our web site – www.intech-edm.com – it will always have the very latest information.

When our wire product lines stabilize and our inventory of obsolete products is exhausted, we will be printing a new wire-cut EDM products catalog and these wire supplements will cease to be necessary.

For those wire products which are undergoing changes in their status, we have added a Status column to the table of sizes, catalog numbers, etc. The notation – *Discontinued but still in stock* – in the Status column indicates that the particular product is discontinued but a limited amount is still available from stock, subject to prior sale. In the case of new wire products, if a date is shown, that indicates the month that we anticipate that product becoming available from stock.

If you have any questions or concerns about these changes, and how it may affect the products you purchase from Intech EDM, please talk to any of our Customer Service staff at 800-323-0295.

Thank you – Intech EDM.

Intech EDM, SuperBrass 500, SuperBrass 900, Alphacut, Deltacut, Betacut, and Multicut 900 are all registered trade marks of Intech Technology Corporation. Cobra Cut is a registered trademark of Berkenhoff GmbH.

Wire Spool Dimensions

Spool Type	"A"		"B"		"C"	
	In	mm	In	mm	In	mm
P-3	4.3	109.2	5.1	129.5	.78	19.8
P-5	4.5	114.3	6.3	160.0	.78	19.8
P-10	5.3	134.6	7.8	198.1	.98	24.9
P-15	5.5	139.7	9.8	248.9	1.33	33.8
DIN 100	3.88	98.6	3.94	100.1	.63	16.0
DIN 125	4.88	124.0	4.88	124.0	.63	16.0
DIN 160	6.25	158.8	6.25	158.8	.86	21.8
DIN 200	7.81	198.4	7.81	198.4	.86	21.8
DIN250	7.87	200.0	9.84	250.0	.87	22.0
Molybdenum	2.5	63.5	3.4	86.4	.63	16.0

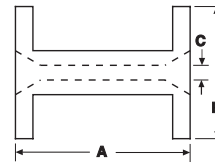

Note: These spool dimensions are provided as general information, and are typical dimensions only. Spool manufacturers are not completely consistent with these dimensions, particularly "B". In general, dimension "C" will be found to be consistent by manufacturer, and dimension "A" will not vary by a significant amount.

EDM

Length of Wire on Spools

This table lists the *approximate* length of wire on various size spools, according to weight. Please note that the length dimensions vary with different manufacturers due to their use of dif-

ferent methods to calculate this value, and as a result can only be considered *estimates*. However, this information should be accurate enough for general job planning purposes.

**U.S.A. Toll-free
1-800-323-0295**
Canada Toll-free
1-800-243-5853

Wire Length - Meters (000)							
Spool Size	Approx. Weight of Wire on Spool		Wire Diameter				
	Kg	Lb	0.004"	0.006"	0.008"	0.010"	0.012"
DIN 100	1.8	4.0	27.3	12.1	6.8	4.4	3.0
DIN 125	3.5	7.7				8.4	
	3.8	8.4	57.4	25.5	14.3	9.2	6.3
	4.0	8.8				9.6	6.6
DIN 160	6.5	14.3		44.0	24.4	15.6	10.7
	8.0	17.6				19.2	13.2
DIN 200	15.0	33.0			56.4	36.1	24.6
	16.0	35.2				38.5	26.3
DIN 250	25.0	55.0			93.75	60.0	41.3
P-3	3.0	6.6		20.1	11.3	7.2	4.9
P-5	5.0	11.0		34.8	18.8	12.0	8.2
	6.0	13.2			18.5	14.5	10.5
P-10	10.0	22.0			38.2	24.0	16.5
P-15	20.0	44.0			76.4	47.9	32.9

SuperBrass 500[®] Standard Tensile



Specifications	
Composition (%) Cu/Zn	63/37
Elongation (%)	18
Tensile Strength (psi)	70,000
(N/mm ²)	500
Diameter Tolerance (mm)	+0/-0.002

EDM

U.S.A. Toll-free
1-800-323-0295

Canada Toll-free
1-800-243-5853

Catalog No.	Diameter		Wire Pack Spool Qty.	Weight* of Wire on Spool		Spool Type	Status
	In	mm		Lbs	Kgs		
W01550S	.006	0.15	1	4.0	1.8	DIN 100	Discontinued but still in stock
W01580	.012	0.30	6	4.0	1.8	DIN 100	Discontinued but still in stock
W01570	.010	0.25					Discontinued but still in stock
W01550	.006	0.15					Discontinued but still in stock
W01575	.010	0.25	4	6.6	3.0	P-3	
W01565	.008	0.20					Discontinued but still in stock
W01581	.012	0.30	4	8.4	3.8	DIN 125	Discontinued but still in stock
W01571	.010	0.25					
W01561	.008	0.20					Discontinued but still in stock

* Average weight per spool.

Call for prices on crate size orders & blanket orders.



SuperBrass 500[®]

Standard Tensile

Wire

Specifications	
Composition (%) Cu/Zn	63/37
Elongation (%)	18
Tensile Strength (psi)	70,000
(N/mm ²)	500
Diameter Tolerance (mm)	+0/-0.002

Catalog No.	Diameter		Wire Pack Spool Qty.	Weight* of Wire on Spool		Spool Type
	In	mm		Lbs	Kgs	
W01586	.012	0.30	4	11.0	5.0	P-5
W01576	.010	0.25				
W01566	.008	0.20				
W01582	.012	0.30	2	14.3	6.5	DIN 160
W01572	.010	0.25				
W01583	.012	0.30	1	33.0	15.0	DIN 200
W01573	.010	0.25				

* Average weight per spool.

EDM

U.S.A. Toll-free
1-800-323-0295
 Canada Toll-free
 1-800-243-5853

60 Day Return Policy • 95% Same-day Service

SuperBrass 900[®] Hi-Tensile



Specifications	
Composition (%) Cu/Zn	63/37
Elongation (%)	1
Tensile Strength (psi)	126,000
(N/mm ²)	900
Diameter Tolerance (mm)	+0/-0.002

EDM

**U.S.A. Toll-free
1-800-323-0295**

Canada Toll-free
1-800-243-5853

Catalog No.	Diameter		Wire Pack Spool Qty.	Weight* of Wire on Spool		Spool Type	Status
	In	mm		Lbs	Kgs		
W01850S	.006	0.15	1	4.0	1.8	DIN 100	
W01840S	.004	0.10					
W01870	.010	0.25	6	4.0	1.8	DIN 100	Discontinued but still in stock
W01850	.006	0.15					
W01840	.004	0.10					
W01885	.012	0.30	4	6.6	3.0	P-3	
W01875	.010	0.25					
W01865	.008	0.20					
W01855	.006	0.15					
W01855S	.006	.015	1	6.6	3.0	P-3	Discontinued but still in stock
W01881	.012	0.30	4	8.4	3.8	DIN 125	
W01871	.010	0.25					
W01861	.008	0.20					

* Average weight per spool.

Call for prices on crate size orders & blanket orders.



SuperBrass 900[®]

Hi-Tensile

Wire

Specifications	
Composition (%) Cu/Zn	63/37
Elongation (%)	1
Tensile Strength (psi)	126,000
(N/mm ²)	900
Diameter Tolerance (mm)	+0/-0.002

Catalog No.	Diameter		Wire Pack Spool Qty.	Weight* of Wire on Spool		Spool Type	Status
	In	mm		Lbs	Kgs		
W01886	.012	0.30	4	11.0	5.0	P-5	
W01876	.010	0.25					
W01866	.008	0.20					Discontinued but still in stock
W01856	.006	0.15					
W01882	.012	0.30	2	14.3	6.5	DIN 160	
W01872	.010	0.25					
W01862	.008	0.20					Discontinued but still in stock
W01883	.012	0.30	1	33.0	15.0	DIN 200	
W01873	.010	0.25					
W01863	.008	0.20					Discontinued but still in stock
W01888	.012	0.30	1	44.0	20.0	P-15	Discontinued but still in stock
W01878	.010	0.25					Discontinued but still in stock
W01868	.008	0.20					Discontinued but still in stock
W01874	.010	0.25	1	55.0	25.0	DIN 250	Made in EU

* Average weight per spool.

EDM

U.S.A. Toll-free
1-800-323-0295
 Canada Toll-free
 1-800-243-5853

60 Day Return Policy • 95% Same-day Service

Standard Brass



Specifications	
Composition (%) Cu/Zn	65/35
Elongation (%)	<2
Tensile Strength (psi)	135,000
(N/mm ²)	930
Diameter Tolerance (mm)	+0/-0.002

Catalog No.	Diameter		Wire Pack Spool Qty.	Weight* of Wire on Spool		Spool Type
	In	mm		Lbs	Kgs	
W0288A	.012	0.30	4	13.2	6.0	P-5
W0287A	.010	0.25				
W02866	.008	0.20				
W02887	.012	0.30	2	17.6	8.0	DIN 160
W02877	.010	0.25				
W02889	.012	0.30	1	22.0	10.0	P-10
W02879	.010	0.25				
W02883	.012	0.30	1	35.2	16.0	DIN 200
W02873	.010	0.25				
W02888	.012	0.30	1	44.0	20.0	P-15
W02878	.010	0.25				

* Average weight per spool.

EDM

**U.S.A. Toll-free
1-800-323-0295**

Canada Toll-free
1-800-243-5853

Call for prices on crate size orders & blanket orders.



Standard Half Hard Brass

Wire

Specifications	
Composition (%) Cu/Zn	65/35
Elongation (%)	<12
Tensile Strength (psi)	70,000
(N/mm ²)	500
Diameter Tolerance (mm)	+0.0004/ -0.002

Catalog No.	Diameter		Wire Pack Spool Qty.	Weight* of Wire on Spool		Spool Type
	In	mm		Lbs	Kgs	
W02571	.010	0.25	4	7.7	3.5	DIN 125
W02576	.010	0.25	4	13.2	6.0	P-5
W02577	.010	0.25	2	17.6	8.0	DIN 160
W02573	.010	0.25	1	35.2	16.0	DIN 200

* Average weight per spool.

EDM

**U.S.A. Toll-free
1-800-323-0295**
Canada Toll-free
1-800-243-5853

60 Day Return Policy • 95% Same-day Service

OKI P Brass Hi-Tensile

Specifications	
Composition (%) Cu/Zn	65/35
Elongation (%)	3
Tensile Strength (psi)	142,000
(N/mm ²)	980
Diameter Tolerance (mm)	±0.001



EDM

U.S.A. Toll-free
1-800-323-0295
Canada Toll-free
1-800-243-5853

Catalog No.	Diameter		Wire Pack Spool Qty.	Weight* of Wire on Spool		Spool Type	Status
	In	mm		Lbs	Kgs		
W01675	.010	0.25	6	6.6	3.0	P-3	
W01665	.008	0.20					
W01686	.012	0.30	4	11.0	5.0	P-5	
W01676	.010	0.25					
W01666	.008	0.20					
W01786	.012	0.30	4	13.2	6.0	P-5	
W01776	.010	0.25					
W01689	.012	0.30	1	22.0	10.0	P-10	
W01679	.010	0.25					
W01669	.008	0.20					
W01673	.010	0.25	1	33.0	15.0	DIN 200	
W01663	.008	0.20					
W01688	.012	0.30	1	44.0	20.0	P-15	
W01678	.010	0.25					
W01668	.008	0.20					

* Average weight per spool.

Discontinued but still in stock

Call for prices on crate size orders & blanket orders.



OKI PN Brass

Hi-Tensile, Non-Paraffin

Wire

Catalog No.	Diameter		Wire Pack Spool Qty.	Weight* of Wire on Spool		Spool Type
	In	mm		Lbs	Kgs	
W01686PN	.012	0.30	4	11.0	5.0	P-5
W01676PN	.010	0.25				
W01666PN	.008	0.20				
W01679PN	.010	0.25	1	22.0	10.0	P-10



Soft Brass

U.S.A. Toll-free
1-800-323-0295
 Canada Toll-free
 1-800-243-5853

Specifications	
Composition (%) Cu/Zn	63/37
Elongation (%)	>28
Tensile Strength (psi)	56,000
(N/mm ²)	400
Diameter Tolerance (mm)	+0/-0.002

Catalog No.	Diameter		Wire Pack Spool Qty.	Weight* of Wire on Spool		Spool Type	Status
	In	mm		Lbs	Kgs		
W01271	.010	0.25	4	8.4	3.8	DIN 125	
W01276	.010	0.25	4	11.0	5.0	P-5	Discontinued but still in stock
W01272	.010	0.25	2	14.3	6.5	DIN 160	

* Average weight per spool.

60 Day Return Policy • 95% Same-day Service

Alphacut® 500

Standard Tensile



Specifications	
Composition (%) Cu/Zn	65/35
Coating	Zn
Coating Thickness (µin)	150
Elongation (%)	18
Tensile Strength (psi)	70,000
(N/mm ²)	500
Diameter Tolerance (mm)	+0/-0.002

Catalog No.	Diameter		Wire Pack Spool Qty.	Weight* of Wire on Spool		Spool Type	Status
	In	mm		Lbs	Kgs		
W10581	.012	0.30	4	8.8	4.0	DIN 125	
W10571	.010	0.25					
W10561	.008	0.20		8.4	3.8		Made in the U.S.A.
W10576	.010	0.25	4	11.0	5.0	P-5	Discontinued but still in stock
W10572	.010	0.25	2	17.6	8.0	DIN 160	
W10573	.010	0.25	1	35.2	16.0	DIN 200	

* Average weight per spool.

EDM

U.S.A. Toll-free
1-800-323-0295

Canada Toll-free
1-800-243-5853

Call for prices on crate size orders & blanket orders.



Alphacut® 800

Hi-Tensile

Wire

Specifications	
Composition (%) Cu/Zn	63/37
Coating	Zn
Coating Thickness (µin)	150
Elongation (%)	1
Tensile Strength (psi)	126,000
(N/mm ²)	900
Diameter Tolerance (mm)	+0/-0.002

Catalog No.	Diameter		Wire Pack Spool Qty.	Weight* of Wire on Spool		Spool Type	Status
	In	mm		Lbs	Kgs		
W10860	.008	0.20	6	4.0	1.8	DIN 100	See Note Below
W10875	.010	0.25	4	6.6	3.0	P-3	
W10865	.008	0.20					
W10881	.012	0.30	4	8.4	3.8	DIN 125	
W10851	.006	0.15					
W10851S	.006	0.15	1	8.4	3.8	DIN 125	
W10841S	.004	0.10					

* Average weight per spool.

Note: This product line is discontinued and transitioning to AgieCut A (see Pages 15-16); all sizes listed are still available from stock.

EDM

U.S.A. Toll-free
1-800-323-0295
 Canada Toll-free
 1-800-243-5853

60 Day Return Policy • 95% Same-day Service

Alphacut® 800 Hi-Tensile



Specifications	
Composition (%) Cu/Zn	63/37
Coating	Zn
Coating Thickness (µin)	150
Elongation (%)	1
Tensile Strength (psi)	126,000
(N/mm ²)	900
Diameter Tolerance (mm)	+0/-0.002

EDM

U.S.A. Toll-free
1-800-323-0295
Canada Toll-free
1-800-243-5853

Catalog No.	Diameter		Wire Pack Spool Qty.	Weight* of Wire on Spool		Spool Type	Status
	In	mm		Lbs	Kgs		
W10886	.012	0.30	4	11.0	5.0	P-5	See Note Below
W10866	.008	0.20					
W10882	.012	0.30	2	14.3	6.5	DIN 160	
W10852	.006	0.15					
W10883	.012	0.30	1	33.0	15.0	DIN 200	
W10873	.010	0.25					
W10863	.008	0.20					

* Average weight per spool.

Note: This product line is discontinued and transitioning to AgieCut A (see Page 15-16); all sizes listed are still available from stock.

Call for prices on crate size orders & blanket orders.

Cobra Cut[®] A

Hi-Tensile

Wire

Specifications	
Composition (%) Cu/Zn	63/37
Coating	Zn
Elongation (%)	1
Tensile Strength (psi)	126,000
(N/mm ²)	900

Catalog No.	Diameter		Wire Pack Spool Qty.	Weight* of Wire on Spool		Spool Type
	In	mm		Lbs	Kgs	
W10840CS	.004	0.10	1	4.0	1.8	DIN 100
W10872C	.010	0.25	2	17.6	8.0	DIN 160
W10852C	.006	0.15				
W10873C	.010	0.25	2	35.0	16.0	DIN 200
W10863C	.008	0.20	1			
W10874C	.010	0.25	2	55.0	25.0	DIN 250

* Average weight per spool.

EDM

U.S.A. Toll-free
1-800-323-0295
 Canada Toll-free
 1-800-243-5853

60 Day Return Policy • 95% Same-day Service

AgieCut A

Hi-Tensile

Specifications	
Core Composition (%) Cu/Zn	63/37
Coating	100% Zn
Coating Thickness (µin)	150
Elongation (%)	1.2
Tensile Strength (psi)	126,000
(N/mm ²)	880
Diameter Tolerance (mm)	+0/-0.002



EDM

U.S.A. Toll-free
1-800-323-0295
Canada Toll-free
1-800-243-5853

Catalog No.	Diameter		Wire Pack Spool Qty.	Weight* of Wire on Spool		Spool Type
	In	mm		Lbs	Kgs	
W10841AS	.004	0.10	1	8.8	4.0	DIN 125
W10871A	.010	0.25	4	8.8	4.0	DIN 125
W10861A	.008	0.20				
W10851A	.006	0.15				
W10841A	.004	0.10				
W10886A	.012	0.30	4	11.0	5.0	P-5
W10876A	.010	0.25				
W10866A	.008	0.20				
W10872A	.010	0.25	2	17.6	8.0	DIN 160
W10862A	.008	0.20				
W10852A	.006	0.15				

* Average weight per spool.

Call for prices on crate size orders & blanket orders.



AgieCut A

Hi-Tensile

Wire

Specifications	
Core Composition (%) Cu/Zn	63/37
Coating	100% Zn
Coating Thickness (µin)	150
Elongation (%)	1.2
Tensile Strength (psi)	126,000
(N/mm ²)	880
Diameter Tolerance (mm)	+0/-0.002

Catalog No.	Diameter		Wire Pack Spool Qty.	Weight* of Wire on Spool		Spool Type
	In	mm		Lbs	Kgs	
W10883A	.012	0.30	1	35.2	16.0	DIN 200
W10873A	.010	0.25				
W10863A	.008	0.20				
W10888A	.012	0.30	1	44.0	20.0	P-15
W10874A	.010	0.25	1	55.0	25.0	DIN 250
W10864A	.008	0.20				

* Average weight per spool.

EDM

U.S.A. Toll-free
1-800-323-0295
 Canada Toll-free
 1-800-243-5853

60 Day Return Policy • 95% Same-day Service

Alphacut® D Hi-Tensile



Specifications	
Composition (%) Cu/Zn	80/20
Coating	Diffused Zinc
Elongation (%)	2
Tensile Strength (psi)	>101,000
(N/mm ²)	>700
Diameter Tolerance (mm)	+0/-0.002

EDM

**U.S.A. Toll-free
1-800-323-0295**

Canada Toll-free
1-800-243-5853

Catalog No.	Diameter		Wire Pack Spool Qty.	Weight* of Wire on Spool		Spool Type
	In	mm		Lbs	Kgs	
W10986	.012	0.30	4	11.0	5.0	P-5
W10976	.010	0.25	4			
W10983	.012	0.30	1	33.0	15.0	DIN 200
W10973	.010	0.25				

* Average weight per spool.

Call for prices on crate size orders & blanket orders.

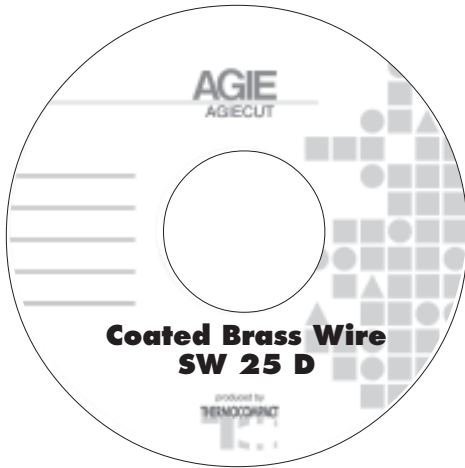

AgieCut SWD

Hi-Tensile

Wire

Specifications	
Composition (%) Cu/Zn	80/20
Coating	Diffused Zinc
Elongation (%)	2
Tensile Strength (psi)	>101,000
(N/mm ²)	>700
Diameter Tolerance (mm)	+0/-0.002

Catalog No.	Diameter		Wire Pack Spool Qty.	Weight* of Wire on Spool		Spool Type
	In	mm		Lbs	Kgs	
W10972	.010	0.25	2	17.6	8.0	DIN 160

EDM

U.S.A. Toll-free
1-800-323-0295
 Canada Toll-free
 1-800-243-5853



Deltacut® 500

Specifications	
Core Composition (% Cu/Zn)	65/35
Surface Composition	65% Zinc-enriched Brass
Surface Layer Thickness (µin)	100-200
Elongation (%)	>15
Tensile Strength (psi)	72,000
(N/mm ²)	500
Diameter Tolerance (mm)	+0/-0.002

Catalog No.	Diameter		Wire Pack Spool Qty.	Weight* of Wire on Spool		Spool Type
	In	mm		Lbs	Kgs	
W30571	.010	0.25	4	7.7	3.5	DIN 125
W30577	.010	0.25	2	17.6	8.0	DIN 160
W30573	.010	0.25	1	35.2	16.0	DIN 200

* Average weight per spool.

60 Day Return Policy • 95% Same-day Service

Deltacut® One

U.S. Patent No. 5,945,010

Specifications	
Core Composition (% Cu/Zn)	65/35
Surface Composition	65% Zinc-enriched Brass
Surface Layer Thickness (µin)	200-500
Elongation (%)	2
Tensile Strength (psi)	125,000
(N/mm ²)	862
Diameter Tolerance (mm)	+0/-0.002



Catalog No.	Diameter		Wire Pack Spool Qty.	Weight* of Wire on Spool		Spool Type
	In	mm		Lbs	Kgs	
W30075	.010	0.25	4	6.6	3.0	P-3
W30081	.012	0.30	4	8.4	3.8	DIN 125
W30061	.008	.020				
W30066	.008	0.20	4	13.2	6.0	P-5
W30089	.012	0.30	1	22.0	10	P-10
W30069	.008	0.20				

* Average weight per spool.

Note: This product line will ultimately be discontinued; all sizes listed are still available from stock as of the cover date. Please call Customer Service for assistance in transitioning to an alternative product.

Call for prices on crate size orders & blanket orders.



Deltacut® 900

Wire

Specifications	
Core Composition (% Cu/Zn)	65/35
Surface Composition	65% Zinc-enriched Brass
Surface Layer Thickness (µin)	100-200
Elongation (%)	<2
Tensile Strength (psi)	135,000
(N/mm ²)	930
Diameter Tolerance (mm)	+0/-0.002

Catalog No.	Diameter		Wire Pack Spool Qty.	Weight* of Wire on Spool		Spool Type	Status
	In	mm		Lbs	Kgs		
W30371	.010	0.25	4	7.7	3.5	DIN 125	
W30386	.012	0.30	4	13.2	6.0	P-5	
W30376	.010	0.25					
W30366	.008	0.20					
W30387	.012	0.30	2	17.6	8.0	DIN 160	Available in June, 2004
W30377	.010	0.25					
W30367	.008	0.20					
W30389	.012	0.30	1	22.0	10.0	P-10	
W30379	.010	0.25					
W30383	.012	0.30	1	35.2	16.0	DIN 200	
W30373	.010	0.25					
W30363	.008	0.20					
W30388	.012	0.30	1	44.0	20.0	P-15	
W30378	.010	0.25					

EDM

**U.S.A. Toll-free
1-800-323-0295**
Canada Toll-free
1-800-243-5853

* Average weight per spool.

60 Day Return Policy • 95% Same-day Service

Betacut® X Standard Tensile



Specifications	
Composition (%) Cu	100
Coating	45% Zinc-enriched Brass
Coating Thickness (µin)	500-1,000
Elongation (%)	1
Tensile Strength (psi)	70,000
(N/mm ²)	500
Diameter Tolerance (mm)	+0/-0.002

Catalog No.	Diameter		Wire Pack Spool Qty.	Weight* of Wire on Spool		Spool Type	Status
	In	mm		Lbs	Kgs		
W12481	.012	0.30	4	8.4	3.8	DIN 125	See Notes Below
W12486	.012	0.30	4	11.0	5.0	P-5	
W12476	.010	0.25					

* Average weight per spool.

Note: This product line is discontinued and transitioning to either Charmilles SW-X (see Page 24), or Betacut X Made in EU (see Page 23); all sizes listed are still available from stock as of cover date.

Call for prices on crate size orders & blanket orders.



Betacut® X

Standard Tensile

Wire

Specifications	
Composition (%) Cu	100
Coating	Cu/Zn
Elongation (%)	1
Tensile Strength (psi)	75,000
(N/mm ²)	520

Catalog No.	Diameter		Wire Pack Spool Qty.	Weight* of Wire on Spool		Spool Type
	In	mm		Lbs	Kgs	
W12471	.010	0.25	4	8.8	4.0	DIN 125
W12461	.008	0.20				
W12487	.012	0.30	2	17.6	8.0	DIN 160
W12472	.010	0.25				
W12483	.012	0.30	1	35.2	16.0	DIN 200
W12473	.010	0.25				
W12484	.012	0.30	1	55.0	25.0	P-15

* Average weight per spool.



U.S.A. Toll-free
1-800-323-0295
 Canada Toll-free
 1-800-243-5853

60 Day Return Policy • 95% Same-day Service

Charmilles Wire SW-X



Specifications	
Composition (%) Cu	100
Coating	Dif. Zn
Coating Thickness (µin)	590
Elongation (%)	<1
Tensile Strength (psi)	>65,000
(N/mm ²)	>450
Diameter Tolerance (mm)	+0/-0.003

EDM

U.S.A. Toll-free
1-800-323-0295

Canada Toll-free
1-800-243-5853

Catalog No.	Diameter		Wire Pack Spool Qty.	Weight* of Wire on Spool		Spool Type
	In	mm		Lbs	Kgs	
W12571	.010	0.25	4	8.8	4.0	DIN 125
W12576	.010	0.25	4	11.0	5.0	P-5
W12582	.012	0.30	2	17.6	8.0	DIN 160
W12572	.010	0.25				
W12583	.012	0.30	1	35.2	16.0	DIN 200
W12573	.010	0.25				

* Average weight per spool.

Call for prices on crate size orders & blanket orders.



Charmilles Wire SW-W

Wire

Specifications	
Composition (% Cu/Zn)	80/20
Coating	Dif. Zn
Elongation (%)	20
Tensile Strength (psi)	>62,000
(N/mm ²)	>430
Diameter Tolerance (mm)	+0/-0.0002

Catalog No.	Diameter		Wire Pack Spool Qty.	Weight* of Wire on Spool		Spool Type
	In	mm		Lbs	Kgs	
W13571	.010	0.25	4	8.8	4.0	DIN 125
W13572	.010	0.25	2	17.6	8.0	DIN 160
W13573	.010	0.25	1	35.2	16.0	DIN 200

EDM

**U.S.A. Toll-free
1-800-323-0295**
Canada Toll-free
1-800-243-5853



Charmilles Wire SW

Specifications	
Composition (%) Cu	100
Coating	Un-annealed Zinc
Coating Thickness (µin)	275
Elongation (%)	1
Tensile Strength (psi)	>58,000
(N/mm ²)	>400
Diameter Tolerance (mm)	+0/-0.0003

Catalog No.	Diameter		Wire Pack Spool Qty.	Weight* of Wire on Spool		Spool Type
	In	mm		Lbs	Kgs	
W11571	.010	0.25	4	8.1	3.7	DIN 125

* Average weight per spool.

60 Day Return Policy • 95% Same-day Service

Charmilles Wire SW-Xcc



Specifications	
Composition (%) Cu	100
Coating	Cu/Zn, Heat Treated
Elongation (%)	1
Tensile Strength (psi)	70,000
(N/mm ²)	500
Diameter Tolerance (mm)	+0/-0.003

Catalog No.	Diameter		Wire Pack Spool Qty.	Weight* of Wire on Spool		Spool Type
	In	mm		Lbs	Kgs	
W12697	.013	0.33	2	17.6	8.0	DIN 160
W12687	.012	0.30				
W12677	.010	0.25				
W12693	.013	0.33	1	35.2	16.0	DIN 200
W12683	.012	0.30				
W12673	.010	0.25				

* Average weight per spool.

EDM

U.S.A. Toll-free
1-800-323-0295
Canada Toll-free
1-800-243-5853

Call for prices on crate size orders & blanket orders.



Multicut 900[®]

Steel Core

Wire

Specifications	
Composition (Core)	Cu-clad Steel
Coating	43% Zinc Enriched Brass
Coating Thickness (µin)	800-1,200
Elongation (%)	1
Tensile Strength (psi)	125,000
(N/mm ²)	890
Diameter Tolerance (mm)	+0/-0.002

Catalog No.	Diameter		Wire Pack Spool Qty.	Weight* of Wire on Spool		Spool Type	Status
	In	mm		Lbs	Kgs		
W14475	.010	0.25	4	6.6	3.0	P-3	See Note Below
W14483	.012	0.30	1	33.0	15.0	DIN 200	

* Average weight per spool.

Note: This product line will ultimately be discontinued; all sizes listed are still available from stock as of the cover date. Please call Customer Service for assistance in transitioning to an alternative product.

EDM

U.S.A. Toll-free
1-800-323-0295
 Canada Toll-free
 1-800-243-5853

60 Day Return Policy • 95% Same-day Service

Molybdenum Wire 15



Specifications	
Composition (%) Mo	100
Elongation (%)	5
Tensile Strength (psi)	280,000
(N/mm ²)	1900
Diameter Tolerance (mm)	±0.001

Catalog No.	Diameter		Wire Pack Spool Qty.	Length* of Wire on Spool (000)	
	In	mm		Ft	M
W22259	.010	0.25	2	3.3	1.0
W22209	.008	0.20			
W22189	.007	0.18			
W22159	.006	0.15	2	9.9	3.0
W22139	.005	0.13			
W22109	.004	0.10			
W22089	.003	0.08			
W22059	.002	0.05			
W22039	.001	0.03	2	16.5	5.0
W22110	.004	0.10			
W22059	.002	0.05			

* Average length per spool. All Molybdenum wire comes standard on a #9 spool. Other spool sizes available on request.

Call for prices on crate size orders & blanket orders.

INTECH EDM[®]



U.S. Toll-free: 800-323-0295

(rings in the office closest to your location)

Canada Toll-free: 800-243-5853

U.S. Headquarters (Chicago)

2001 Parkes Drive • Broadview, IL 60155-3952

Tel: 708-681-6110 • Fax: 708-681-0447 or 800-325-7584

West Coast Office (Los Angeles)

22138 S. Vermont, Unit G • Torrance, CA 90502

Tel: 310-328-1060 • Fax: 310-328-0215

Northwestern Office (Seattle)

238 SW 43rd Street • Renton, WA 98055

Tel/Fax: 425-251-4979

Northeastern Office (Boston)

81 West Street • Attleboro, MA 02703-1618

Tel: 508-222-1338 • Fax: 508-222-1165

Arizona Office (Phoenix)

2328 West Campus Dr., Suite 102 • Tempe, AZ 85282

Tel: 602-242-0800 • Fax: 480-967-9255

Canadian Office (Toronto)

6975-D Pacific Circle • Mississauga, Ontario L5T 2H3

Tel: 905-565-6942 • Fax: 905-565-6945

Internet

E-Mail: info@intech-edm.com

Web Site: www.intech-edm.com